

Gavita **Master** Controller EL1



User manual

User manual

Gavita Master controller EL1

Dear Customer,

Congratulations on the purchase of your Gavita Master controller EL1.

This manual contains all the information necessary to install, use and maintain the Gavita Master controller EL1. Please read and understand this manual completely before installing and using the product.

Consult the index at the start of this manual to locate information relevant to you.

In this manual, the Gavita Master controller EL1 will be referred to as the controller.

This is the original manual, keep it in a safe location!

Table of content

| | |
|--|-----------|
| 1. Introduction | 7 |
| 1.1. Product description | 7 |
| 1.2. Glossary of Terminology | 7 |
| 1.3. Used symbols | 8 |
| 2. Product specifications | 8 |
| 2.1. General product information | 8 |
| 2.2. Technical specifications | 8 |
| 2.3. Environment | 8 |
| 2.4. Required tools | 8 |
| 2.5. Components | 9 |
| 2.6. Controls | 9 |
| 2.7. Indications | 10 |
| 2.8. Connections | 11 |
| 2.9. Accessories | 11 |
| 2.10. Compatible ballasts | 11 |
| 3. Safety guidelines and measures | 12 |
| 4. Installing the controller | 12 |
| 4.1. Placing the controller | 12 |
| 4.2. Installing and connecting the temperature sensor | 13 |
| 4.2.1. Installing the temperature sensor | 14 |
| 4.3. Connecting the controller to the ballasts | 15 |
| 4.3.1. Connecting the controller to remote ballasts | 15 |
| 4.3.2. Connecting the controller to complete fixtures | 16 |
| 4.3.3. Shortening RJ cables | 17 |
| 4.4. Connecting the controller to the mains | 17 |
| 5. Preparations before use | 18 |
| 5.1. Localizing your controller | 19 |
| 5.1.1. Selecting your default language | 19 |
| 5.1.2. Switching between 24 hour and AM/PM clock mode and setting the time | 19 |
| 5.1.3. Switch temperature units between °Fahrenheit and °Celsius | 20 |
| 5.2. Calibrating the temperature sensor | 20 |
| 5.3. Change the display mode from the controller output from % to Watts | 21 |

| | |
|---|-----------|
| 6. Programming and using the controller | 23 |
| 6.1. Adjust ballast output to change light intensity | 23 |
| 6.1.1. Control a lamp with a lower power rating than its ballast | 23 |
| 6.2. Programming a light cycle | 23 |
| 6.3. Set temperature safety settings | 24 |
| 6.3.1. Setting the auto-dim temperature | 24 |
| 6.3.2. Setting safety shutdown temperature | 25 |
| 6.4. Setting the sunrise and sunset period | 26 |
| 6.5. Activate or deactivate the lights manually or set automatic mode | 26 |
| 6.6. Resetting the controller to factory settings | 27 |
| 7. Interpreting controller information | 28 |
| 7.1. Reading the default screen | 28 |
| 7.2. Interpreting LED signals | 28 |
| 7.2.1. Green light (16A) | 28 |
| 7.2.2. Blue light (16C) | 29 |
| 7.2.3. Red light(16D) | 29 |
| 7.3. Interpreting display messages | 29 |
| 7.3.1. Sensor disconnected | 29 |
| 7.3.2. Sensor failure | 29 |
| 7.3.3. Controller Overload | 29 |
| 7.3.4. Auto-dim | 30 |
| 7.3.5. Temp Alarm | 30 |
| 7.4. View the software version on the controller | 30 |
| 8. Maintenance and Repair | 31 |
| 9. Environment and Disposal | 31 |
| 10. Warranty | 31 |

1. Introduction

1.1. Product description

The Gavita Master controller EL1 is a single channel controller which can control up to 40 ballasts/lights in a climate room.

Unlike a switchboard, which switches the power supply of regular ballasts on and off, the controller can control appropriate Gavita e-series ballasts by means of a low voltage control signal.

The ballasts and lights connected to the controller form a significant heat source within the climate room. If for whatever reason, the climate control system cannot prevent the temperature from rising in the climate room, the lights should be dimmed or even shut down to prevent crop damage. The controller offers the possibility to set the temperature at which it will dim the lights and a temperature at which it will shut the lights down. The controller is not meant to replace climate control equipment. Its auto-dim and shutdown function are primarily meant to prevent crop damage.

The controller is equipped with a 16x2 character green OLED display, which ensures high contrast and clarity in dark and light environments. It provides a self-explaining menu system with a full text interface for extremely easy and intuitive use. There is no need to go through a code table to set your controls or read your statuses. The system is also equipped with LEDs as status indicators to see the status of your controller at a glance.

The interface language is user selectable: English, Spanish, French, German and Dutch are standard available.



The Controller uses a low DC voltage to control both ballasts and contactor modules, making the system safe to install. Cables for plug & play installation are provided with the controller and the ballasts.

1.2. Glossary of Terminology

| | |
|-------------------|---|
| EL | Entry level |
| Light cycle | A 24 hour period in which the lights are activated and deactivated once |
| Lights-on period | The period of the light cycle in which the lights are activated |
| Lights-off period | The period of the light cycle in which the lights are not activated |
| Cage clamp | Wire clamp |
| Ballast | A ballast is a device intended to ignite and power HID lamps |
| Complete fixture | A ballast integrated with a reflector and lamp |

1.3. Used symbols

The following icons will be used throughout the manual:

-  **Warning!** A warning indicates severe damage to the user and/or product may occur when a procedure is not carried out as described.
-  **Caution!** A caution sign indicates problems may occur if a procedure is not carried out as described.
-  **Note/Example:** A note or example provides tips and addition information to the user.

2. Product specifications

2.1. General product information

| | |
|--------------|-------------------------|
| Product name | Master controller EL1 |
| Product code | 41.00.XX.XX |
| Producer | Gavita International bv |

2.2. Technical specifications

| | |
|--|--|
| Controller dimensions (LxWxH) | 127 x 22 x 75 mm |
| Weight | 160 gram |
| Power supply | Adapter: 100V-240V AC 50/60hz - 5V DC (2000mA) |
| Maximum control voltage | 11.5V |
| Maximum voltage/current alarm contacts (NO/NC) | 13,5V/50mA |
| Maximum cable length per port | 100m (328ft) |
| Maximum number of ballasts per port | 40 |
| Total number of ballasts per controller | 40 |

2.3. Environment

-  **Warning!** The product may not be exposed to moisture, condensing humidity, contamination or dust.

| | |
|-------------------------------------|----------------------|
| Temperature range | 0-35 °C / 32 - 95 °F |
| Operating humidity (non-condensing) | <80% |

2.4. Required tools

| Task | Tool |
|--------------------------------|-----------------|
| Mounting controller | Screwdriver |
| Mounting controller | Drill |
| Modify cable length (optional) | RJ14 crimp tool |

2.5. Components

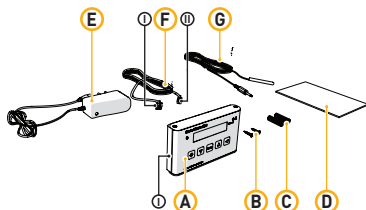

- A. Gavita Master controller EL1
 - I. Mounting plate
- B. 2x Countersunk screw
- C. 2x Plug
- D. Manual
- E. 120-240V AC - 5V DC power adapter (2000mA)
- F. 1x Controller cable (5m/16ft)
 - I. RJ14 (6P4C) plug (connect to ballasts)
 - II. RJ9 (4P4C) plug (connect to controller)
- G. 1x Temperature sensor with cable (5m/16ft)

2.6. Controls

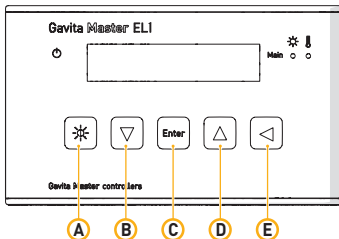

| | Key | Function |
|---|-----------|--------------------------------------|
| A | Quick-key | View and adjust output level |
| B | Down | Navigate down in menu/decrease value |
| C | Enter | Go to menu/confirm |
| D | Up | Navigate up in menu/increase value |
| E | Back | Navigate back in menu/cancel/reset |

2.7. Indications

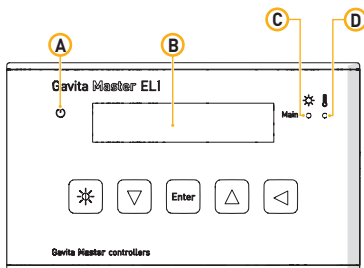

For more information on indications go to chapter 7

| | Indication signal | Function |
|---|--------------------------|--|
| A | Power indication | A burning green light indicates controller is active. A blinking green light indicates a power interruption has occurred during operation. |
| B | Display | Displays status, warnings and controller menu. |
| C | Light indication main | A burning blue light indicates the port is active. A blinking blue light indicates an overload / short circuit in a cable connected to the port. Blue light off indicates the port is inactive. |
| D | Temperature warning main | A burning red light indicates the auto-dim temperature has been exceeded in the past. A blinking red light indicates the auto-dim temperature threshold is currently exceeded. The corresponding output channels are being dimmed. A fast blinking red light indicates the shutdown temperature threshold has been exceeded. All output channels have been shut down. |

2.8. Connections

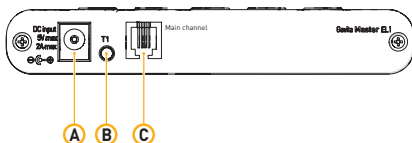

- A. 5V DC input
- B. 3,5 mm jack main temperature sensor (T1)
- C. RJ9 (4P4C) Main port for controlling up to 40 ballasts

2.9. Accessories

- Note:** Accessories are not included, they have to be bought separately. Visit the website of Gavita International: www.gavita.com for the latest Gavita products.

| Part | Variants | Product code |
|--|---------------------------------------|--------------|
| Interconnect cable (RJ14-RJ14) | 2 ft / 0,60 m | 43.50.00.08 |
| | 5 ft / 1.5 m - standard cable | 43.50.00.04 |
| | 8 ft / 2.4 m | 43.50.00.09 |
| | 10 ft / 3.0 m | 43.50.00.10 |
| Controller cable (RJ9-RJ14) | 5 ft / 1.5 m | 43.50.00.11 |
| | 16 ft / 5 m - standard cable | 43.50.00.12 |
| | 25 ft / 7.5 m | 43.50.00.13 |
| Three-way RJ14 Splitter | | 43.50.00.01 |
| Power supply Gavita Master Controller EL1 / EL2 (with 2 m cord, universal voltage 120-240 V) | US version 120V | 42.02.02.03 |
| | UK version 240V | 42.02.02.02 |
| | EU version 230V | 42.02.02.02 |
| | AUS version 240V | 42.02.02.05 |
| Temperature sensor (with 5 m cable - 3.5 mm mini jack plug) | 16 ft / 5.0 m cable length - standard | 42.50.00.14 |

2.10. Compatible ballasts

- Note:** Ballasts are not included, they have to be bought separately. Visit the website of Gavita International: www.gavita.com for the latest Gavita products.

The Gavita Master controller EL1 is compatible with all Gavita e-series ballasts.

3. Safety guidelines and measures

- ⚠ **Warning!** Keep the controller away from fire, excessive heat, water, dust and contamination.
- ⚠ **Warning!** The Gavita Master controller EL1 may only be used to control compatible Gavita e-series ballasts. Do not connect the Controller to other products as this may be dangerous and may cause malfunctions in the connected equipment. Doing so will void the warranty.
- ⚠ **Warning!** Do not open or disassemble the controller, it contains no serviceable parts. Opening the controller will void its warranty.

4. Installing the controller

4.1. Placing the controller

- ⚠ **Warning!** The area in which the product is placed must comply with the conditions specified in paragraph 2.3.

⚠ **Caution!** Only mount the product on a sturdy, solid background.

📌 **Note:** Use the included plugs for hard surfaces.

- Determine the optimal location for the controller
- Carefully pry the mounting clamp from the controller using a prying tool or a flat head screwdriver (1) (tape it to prevent damage to the housing).

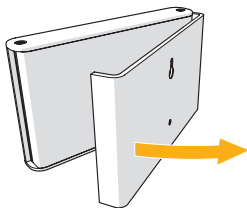

1 Removing mounting clamp

- Hang the controller mounting plate against the desired surface using one of the countersunk screws (2A)
- Secure the mounting plate with a second screw (2B)
- Click the controller on the mounting clamp (3).

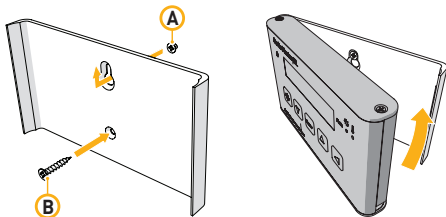

- 2 Hanging the mounting clamp 3 Clicking the controller on the clamp

4.2. Installing and connecting the temperature sensor

- ⚠ Warning!** The Gavita Master controller is not a climate controller. Do not use the product to manage the temperature in your climate room.
- ⚠ Caution!** Only use Gavita temperature sensors.
- ⚠ Caution!** Ensure the controller measures the same temperature as the climate control system (see paragraph 5.2).

The controller can only be used when it is connected to the temperature sensor. The controller uses these sensor to monitor the temperature in the climate room. The controller will automatically dim or shut down the lights if the temperature in the climate room becomes too high. For more information on temperature safety, consult paragraph 6.3.

4.2.1. Installing the temperature sensor

- Place the provided temperature sensor as close as possible to the sensor of the existing climate control system, so both sensors will measure the same temperature (4A)
- Ensure the sensor is covered from the light, as this will disrupt temperature measurements. Use a hood if necessary (4B). A template for a hood is included on the last page
- Insert the plug of the temperature sensor into the T1 port (4C)
- The temperature measured by the sensor will be displayed on the controller display.

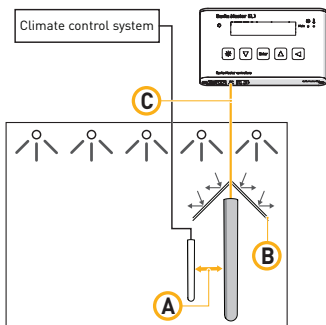

4 Placing a temperature sensor

- ! **Note:** The displayed temperature may take some time to level out.
- ! **Note:** If the length of the sensor cable is insufficient to reach the controller, try to relocate the controller. If this is not possible, the sensor cable may be lengthened an extra 5 meters by using a standard 3,5 mm jack extension cable. If the message "sensor removed" appears, the plug of the sensor is not (fully) plugged in. Plug the sensor in completely.
- ! **Note:** If the message "sensor failure" appears, the sensor is defect. Replace the sensor.

4.3. Connecting the controller to the ballasts

Warning! The controller may only be connected to compatible Gavita e-series remote ballasts and complete fixtures. For a list of compatible products, consult paragraph 2.10 or go to www.gavita.com.

Note: for more information on shortening RJ cables, consult paragraph 4.3.3.

A group of up to 40 e-series ballasts can be connected to the RJ9 port of the controller. Consult paragraph 4.3.1 to connect the controller to remote ballasts. Consult paragraph 4.3.2 to connect the controller to complete fixtures.

4.3.1. Connecting the controller to remote ballasts

Warning! When connecting the fixture to the controller it may ignite. Make sure either fixture power is disconnected or the controller is switched off.

Warning! Ensure the remote ballasts are connected to their lamps and reflectors.

- Switch the rotary knob on all Gavita ballasts to "EXT" (external control)
- Plug the RJ9 end of one of the controller cable (5A) into the RJ9 main port of the controller.
- Plug the RJ14 end of the controller cable(s) into one of the two RJ14 ports of the first ballast (5B)
- Interconnect the remote ballast to the next ballast in line using an interconnect cable with RJ14 plugs (5C). Up to 40 ballasts may be daisy chained this way.

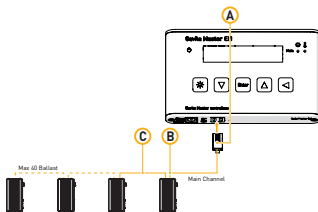

5 Connecting the controller to remote ballasts

4.3.2. Connecting the controller to complete fixtures

⚠ Warning! When connecting the fixture to the controller it may ignite. Make sure either fixture power is disconnected or the controller is switched off.

! Note: A RJ14 splitter and two cables are provided with each complete fixture since complete fixtures have only one RJ14 port.

- Switch the rotary knob on all Gavita ballasts to "EXT"
- Plug the RJ9 end of the provided controller cable into the RJ9 main port of the controller (6A)
- Plug the RJ14 end of the controller cable(s) (6B) into the input of a RJ14 splitter (6C). Use an interconnect cable to connect one output of the RJ14 splitter to the RJ14 port of the ballast (6D)
- Use an interconnect cable to connect one output of the RJ14 splitter to the input of the following RJ14 splitter (6E)
- Repeat this process to connect up to 40 ballasts.

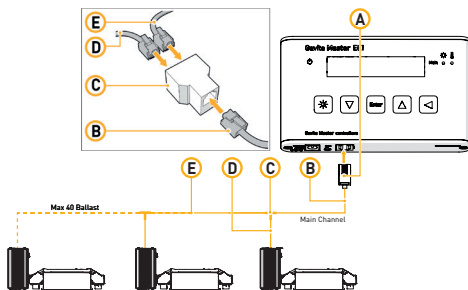

6 Connecting the controller to complete fixtures

4.3.3. Shortening RJ cables

- ❗ **Note:** A RJ14 crimp tool is needed to shorten a RJ cable and install a RJ14 plug!
- ❗ **Note:** Don't remove RJ9 plugs unless you have a RJ9 crimp tool!
- ⚠ **Caution!** Always follow the instructions provided with the crimp tool!
 - Shorten the cable on the desired length
 - Strip the outer insulation off the RJ cable (8 mm). Leave the inner insulation intact!
 - Push the four wires into the middle openings of a RJ14 plug. The orientation of the plug does not matter as long as the wires are entered in the central four openings (7A).
- ⚠ **Caution!** If the wires are not inserted in the middle of the plug, the wires will short circuit, when plugged into a ballast or complete fixture, causing a controller overload (7B, see also paragraph 7.3.3).
 - Crimp the RJ 14 plug on the RJ wire.

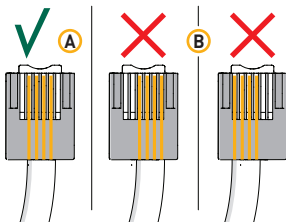

7 Wiring a RJ14 plug

4.4. Connecting the controller to the mains

- ⚠ **Warning!** When you power on the controller, the connected ballasts may ignite. Either:

- a) make sure your ballasts are not connected to mains yet or
- b) the signal cable of the ballasts is not inserted in the controller yet

before connecting and programming the controller.

- Plug the adapter into the AC outlet
- Plug the DC connector of the adapter into the DC inlet of the controller. (8A) The green power indication (8B) will start blinking, to indicate the power was interrupted

- Hold the reset button ◀ for 3 seconds. The green power indication will start to burn continuously.

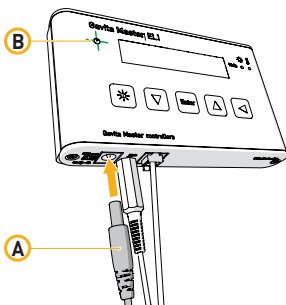

8 Connecting the controller to the mains

5. Preparations before use

⚠ Caution! Set the controllers output mode to "OFF" (see paragraph 6.5.) to ensure no ballasts will be accidentally activated during the controller setup. After this it is safe to either connect the ballasts to mains or insert the signal cable to the ballasts into the controller.

! Note: after 60 seconds of inactivity the controller interface will return to the main menu.

! Note: to leave any screen without saving changes, press the arrow key ▶

! Note: lesser used functions can be accessed faster by clicking the arrow key ▲

- Ensure you have carried out all applicable steps from chapter 4
- Plug the ballast in the mains. The status led on the ballast will indicate that they are connected to the controller
- Examine whether all LEDs show the correct code. Check the connections when you see an error code. In case an overload is indicated on the controller display please check if you did not make a cabling error connecting a RJ connector (see paragraph 4.3.3.)
- Verify your controller is ready for use by performing the actions described in this chapter.

5.1. Localizing your controller

5.1.1. Selecting your default language

The controller can be set to five languages: Dutch, English, German, French and Spanish.

- Press "enter", the controller menu will open
- Press the arrow keys ▲▼ to locate "language" and press "enter". The "language" screen will open
- Press the arrow keys ▲▼ to locate your language. Press "enter" to confirm your choice and return to the controller menu.

5.1.2. Switching between 24 hour and AM/PM clock mode and setting the time

- Press "enter", the controller menu will open
- Press the arrow keys ▲▼ to locate "System time" and press "enter". The "System Time" screen (9) will open. In this screen the "clock mode" indication blinks (9A)
- Press the arrow keys ▲▼ to switch between the 24-hour and the AM/PM-hour clock mode. Press "enter" to confirm your choice. The "hour" indication (9B) will start blinking
- Press the arrow keys ▲▼ to select the correct hour. In a AM/PM-hour clock mode, continue pressing to select AM/PM. Press "enter" to confirm.
- Use the same procedure to set the "minutes" (9C). Press "enter" to confirm your choice and return to the controller menu.

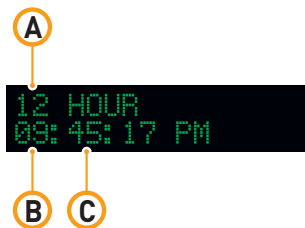

9 Switching clock mode and setting the time

5.1.3. Switch temperature units between °Fahrenheit and °Celsius

- Press "enter", the controller menu will open
- Press the arrow keys ▲▼ to locate "Temp units" and press "enter". The "temperature units" screen will open
- Press the arrow keys ▲▼ to switch between °F and °C. Press "enter" to confirm your choice and return to the controller menu.

5.2. Calibrating the temperature sensor

⚠ Caution! The controller will not immediately display the correct temperature when the sensor is plugged in. The sensor will take some time to respond to temperature changes.

⚠ Caution! To allow for accurate temperature management within the climate room, the temperature measured by the controller must match the temperature measured by the climate control system. If these values do not match, the temperature safety system of the Gavita controller may interfere with the climate control system.

⚠ Caution! Always place the temperature sensor of the controller as close as possible to the temperature sensor of the climate control system.

If necessary, the temperature measured by the Gavita controller can be adjusted to match the temperature measured by the climate control system.

- Press "enter", the controller menu will open
- Press the arrow keys ▲▼ to locate "Calibrate" and press "enter".

The "Calibration" screen will open (10). This screen displays the temperature measured by the main temperature sensor "T1". If the temperature sensor is not or incorrectly connected, the text "removed" or "failure" will be displayed.



10 Calibrating the temperature sensor

- Press "enter" to select the temperature value you wish to adjust
- Use the arrow keys ▲▼ to adjust the temperature to the desired value and press "enter" to confirm your choice.

- ! **Note:** The calibrated temperature values are stored in the internal memory of the controller. Resetting the controller will restore these values (see paragraph 6.6).

5.3. Change the display mode from the controller output from % to Watts

- ⚠ **Caution!** The wattage displayed by the controller only serves as a visual aid, calculating the output in wattage from the set percentage. If a 400W ballast model is selected in the controller but a 1000W ballast is connected, the ballast will still provide a 1000W output at 100%.
- ⚠ **Warning!** Always use the % setting when ballasts with different wattages are used simultaneously.

By default the controller represents ballast output as a percentage of the total output (11A). The controller can also convert this percentage into Watts if the wattage of the ballast is known.

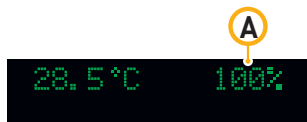

11 Default output display

- Press "enter", the controller menu will open
- Press the arrow keys ▲▼ to locate "Display mode" and press "enter". The "Display mode" screen opens
- Press the arrow keys ▲▼ to select which type of ballasts you have connected: 400W, 600W, 750W, 1000W, or select percentage in a mixed environment
- Press "enter" to confirm your choice.

The "main" screen and the "output level" screen (see paragraph 6.1) will now represent the ballast output in Watts (12B).



12 Output display in Watts

6. Programming and using the controller

⚠ Caution! Set the controllers output mode to "OFF" (see paragraph 6.5.) to ensure no ballasts will be accidentally activated during the controller setup.

Follow the actions listed below to quickly start using the controller.

- Set the controller output level (see paragraph 6.1)
- Program a light cycle (see paragraph 6.2)
- Set the auto-dim temperature (see paragraph 6.3.1)
- Set the shutdown temperature (see paragraph 6.3.2)
- Set sunrise/sunset period (optional) (see paragraph 6.4)
- Activate the auto mode on the controller (see 6.5.).

6.1. Adjust ballast output to change light intensity

The controller can set the output of a ballast between 50 and 115 percent. Adjusting this ballast output enables the user to change the light intensity in the climate room.

- Press the * quick-key, the "output level" screen opens
- Press the arrow keys ▲▼ to set the ballast output between 50 and 115 percent (400W, 600W and 750W fixtures can only be boosted up to 110%)
- Press "enter" to confirm your choice.

ⓘ Note: the output level can also be found in the general menu.

6.1.1. Control a lamp with a lower power rating than its ballast

⚠ Warning! When fitting a lamp with a lower output than its ballast, ALWAYS adjust the output level of the ballast before switching the light on. Failing to do will cause immediate damage to the lamp.

A ballast may be used to control a lamp with a lower power output than the nominal value of the ballast. For example: a 1000 watt ballast set at 750 watt can be used to control a 750 watt lamp. To prevent damage to the light, the controller output must be adjusted to the appropriate value.

- Disconnect the ballast(s) from the mains
- Make sure the display mode of the controller is set to represent the output power of your ballast, NOT of your lamp (see paragraph 5.3)
- Adjust the ballast output to match the wattage of the lamp (see paragraph 6.1)
- Exchange the lamps of all connected ballasts
- Reconnect the ballast to the mains.

6.2. Programming a light cycle

- Press "enter", the controller menu will open
- Press the arrow keys ▲▼ to locate "Light Cycle" and press "enter". The "Light Cycle" screen will open. (13) In this screen the hour indication behind "ON" blinks (13A)

- Press the arrow keys ▲▼ to select the hour on which the lights must be activated and press “enter” to confirm your choice.
- Use the same procedure to set the minute (13B) on which the lights must be activated and the hour (13C) and minute (13D) on which the lights must be deactivated.

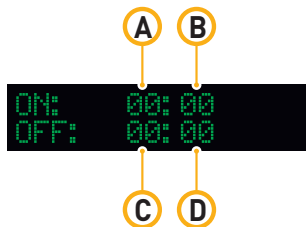

13 Programming a light cycle

6.3. Set temperature safety settings

When the temperature in a climate room gets above a certain value, the planted crops will start to degrade. If this rise in temperature occurs, it is desirable to dim or shut down the lights in the climate room to reduce the temperature in the room.

The controller offers the possibility to set a temperature at which it will dim the lights and a temperature on which it will shut down the lights. Through its temperature sensor, it can sense when a harmful temperature is reached. To set the auto-dim temperature, go to paragraph 6.3.1. To set the shut-down temperature, go to paragraph 6.3.2.

6.3.1. Setting the auto-dim temperature

- ⓘ **Note:** The default auto-dim temperature is set at 30 °C / 86 °F.
- ⓘ **Note:** The auto-dim temperature cannot be set higher than the shutdown temperature.
- ⓘ **Note:** The auto-dim will decrease the light intensity to 50% over a span of two degrees Celsius or 3,6 degrees Fahrenheit (14)
- ⚠ **Warning!** Always set the auto-dim temperature at least two degrees Celsius / 3,6 degrees Fahrenheit above the temperature of the climate control system. This will prevent the controller from interfering with the climate control system.

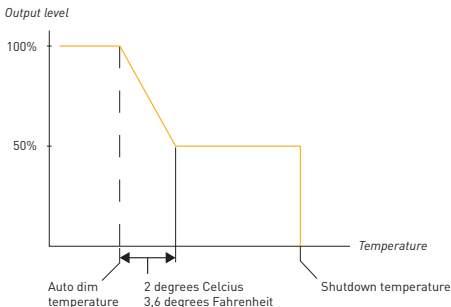

14 Auto-dim and shutdown behavior

- Press "enter", the controller menu will open
- Press the arrow keys ▲▼ to locate "Auto-Dim Temp" and press "enter". The auto-dim temperature screen opens
- Press the arrow keys ▲▼ to increase or decrease the temperature.
- Press "enter" to confirm.

Once the auto-dim temperature is reached, the controller will automatically start dimming the lights. No auto-dim will occur if the shutdown temperature is set at the auto-dim temperature.

- ⚠ **Note:** the auto-dim will stay on until half a degree Celsius / 0,9 degrees Fahrenheit under the set temperature.

6.3.2. Setting safety shutdown temperature

- ⚠ **Note:** The default shutdown temperature is set at 35 °C / 95 °F.
- ⚠ **Note:** The safety shutdown temperature of the controller cannot be set lower than the auto-dim temperature.
- ⚠ **Warning!** Always set the shutdown temperature so it does not accidentally deactivate the lights.
- ⚠ **Warning!** After a shutdown, a manual reset is required.

- Press "enter", the controller menu will open
- Press the arrow keys ▲▼ to locate "Shutdown Temp" and press "enter".

- The “Shutdown temperature” screen opens
- Press the arrow keys ▲▼ to increase or decrease the temperature.
- Press “enter” to confirm.

Once the shutdown temperature is reached (14), the controller will automatically shut down all the lights..

6.4. Setting the sunrise and sunset period

To allow crops to adjust to either a lights-on or lights-off period, a sunrise and sunset period may be set. During this period, the light intensity increases from 50 percent to up to the desired intensity.

- Press “enter”, the controller menu will open
- Press the arrow keys ▲▼ to locate “Sunrise/sunset” and press “enter”. The “Set ramp time” screen opens
- Press the arrow keys ▲▼ to increase the ramp up/down time to up to 30 minutes. 0 minutes indicates no ramp up/down time
- Press “enter” to confirm your choice.

6.5. Activate or deactivate the lights manually or set automatic mode

⚠ Warning! When replacing a light, setting the ballast to “Off” to override the clock is insufficient! ALWAYS disconnect the ballast from the mains.

⚠ Warning! When the controller “Output mode” is set to “on” or “off”, the temperature safety features of the controller will not work.

! Note: The on and off mode are included to allow for replacement of ballasts and testing of lamps.

- Press “enter”, the controller menu will open
- Press the arrow keys ▲▼ to locate “Output mode” and press “enter”
- Press the arrow keys ▲▼ to switch between “auto”, “on” and “off”
 - Select “on” to turn all the lights on. This setting will ignore temperature safety settings. (see paragraph 6.3)
 - Select “off” to turn all the lights off
 - Select “auto” to follow the programmed light cycle (see paragraph 6.2) and temperature safety settings (see paragraph 6.3)
- Press “enter” to confirm your choice.

6.6. Resetting the controller to factory settings

The factory reset will return all values to factory settings. It will also undo any changes to the temperature calibration of the temperature sensors.

- Press "enter", the controller menu will open
- Press the arrow keys ▲▼ to locate "Factory Reset" and press "enter".
The "Factory Reset" screen opens
- Press the arrow keys ▲▼ to switch to "yes" and press "enter".
The controller is now reset to factory settings.

7. Interpreting controller information

7.1. Reading the default screen

The default screen displays the temperature measured by the temperature sensor (15A) and the system time. The screen also displays the output of the channels, either in % or in Watts (15B). If an error occurs, it may also be displayed in the display. (See paragraphs 7.2 and 7.3 for potential error messages).

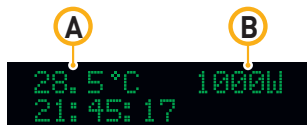

15 Default screen

7.2. Interpreting LED signals

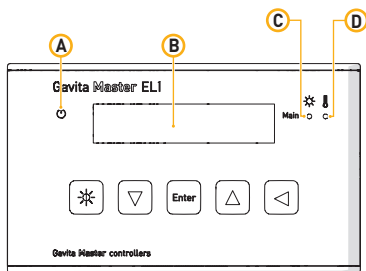

16 LED signals

7.2.1. Green light (16A)

A burning green light indicates the controller is functioning.

A blinking green light indicates the power has been interrupted.

After a power failure the blinking green indicator must be reset;

- Hold the reset button ◀ for three seconds to reset the indicator.

7.2.2. **Blue light (16C)**

A burning blue light indicates the connected ballasts are activated.

A blinking blue light indicates an overload (see paragraph 7.3.3).

When a blue light is off, it indicates the connected ballasts are deactivated.

7.2.3. **Red light (16D)**

A blinking red light indicates the auto-dim temperature is exceeded (see paragraph 7.3.4).

A fast blinking red indicates the shutdown temperature has been exceeded (see paragraph 7.3.5).

A burning red light indicates the auto-dim temperature has been exceeded in the past (see paragraph 7.3.4).

7.3. **Interpreting display messages**

7.3.1. **Sensor disconnected**

The message "Sensor disconnected" appears when the temperature sensor is not plugged in. All devices connected to the controller are deactivated.

- Plug in the missing sensor to resolve.

7.3.2. **Sensor failure**

If the message "sensor failure" appears, the sensor is defect. All devices connected to the controller are deactivated. The controller must be reset.

- Replace the temperature sensor
- Hold the reset button ◀ for 3 seconds.

7.3.3. **Controller Overload**

If the message "controller overload" appears, the main channel has been overloaded. The blue led indicator behind the overloaded channel will also start flashing. An overload may occur when the wiring connected to the main channel of the controller has short circuited. All devices connected to the controller will be deactivated. The controller must be reset;

- Search for faulty wiring or contacts and replace it
- Hold the reset button ◀ for 3 seconds.

7.3.4. Auto-dim

When the auto-dim temperature has been exceeded, the message "auto dim" will appear on the display. The red light will also flash. The flashing will continue until the temperature drops half a degree Celsius/ 0.9 degrees Fahrenheit below the auto-dim temperature for at least 30 seconds.

A burning red light indicates the auto-dim temperature has been exceeded in the past.

- To resolve a burning red light, hold the reset button ◀ for three seconds to reset the warning.

7.3.5. Temp Alarm

When the shutdown temperature has been exceeded, the message "Temp alarm" will appear on the display and the red light will flash rapidly. All devices connected to the controller are deactivated. The controller must be reset;

- Ensure the temperature of the room is below the shutdown temperature. If the temperature is still above shutdown temperature, the controller cannot be reset
- Hold the reset button ◀ for three seconds to reset the controller (see for more information about wiring the RJ4 connector paragraph 4.3.3).

7.4. View the software version on the controller

Your reseller or Gavita International bv may request the software version of your controller to check for compatibility with (future) Gavita products.

- Remove the DC plug from the controller (your data will be saved by an internal battery)
- Plug the DC plug back in, the software version will be displayed for a few seconds [17].



17 Example display software version

8. Maintenance and Repair

- ⚠ **Warning!** Do not open or disassemble the controller, it contains no serviceable parts. Opening the controller will void its warranty.
- ⚠ **Warning!** Do not use acids, solvents, abrasives or other aggressive substances to clean the controller as this may cause damage.

The Gavita Master controller EL1 is maintenance free.

- The Controller may be cleaned with a soft dry cloth
- Please contact your reseller in case of controller malfunction.

9. Environment and Disposal

ATTENTION: THIS PRODUCT CONTAINS A BATTERY.
MUST BE DISPOSED OF PROPERLY.



The symbol on the material, accessories or packaging indicates that this product may not be discarded as household waste. Dispose of the equipment through a recycling center that handles electronics and electrical appliances within the EU and in other European countries which use separate collection systems for used electronics and electrical appliances. By disposing of the equipment in the proper way, you will be helping to prevent possible risks to the environment and public health, which might otherwise be caused by improper handling of the discarded equipment. Recycling of materials contributes to the conservation of natural resources. Therefore, please do not dispose of your old electronics and electrical appliances via household waste.

10. Warranty

Gavita International bv warrants the mechanical and electronic components of their product to be free of defects in material and workmanship if used under normal operating conditions for a period of two (2) years from the original date of purchase. If the product shows any defects within this period and that defect is not due to user error or improper use Gavita International bv shall, at its discretion, either replace or repair the product using suitable new or reconditioned products or parts. In case Gavita International bv decides to replace the entire product, this limited warranty shall apply to the replacement product for the remaining initial warranty period, i.e. two (2) years from the date of purchase of the original product. For service return the product to your shop with the original sales receipt.

Appendix I – Overview of all screens on display

| | | | |
|----------|---|---------------------------------------|--|
| | <div>▶OUTPUT MODE OUTPUT LEVEL</div> | <div>OUTPUT MODE ▶AUTO</div> | <div>OUTPUT MODE ▶ON</div> |
| | <div>OUTPUT MODE ▶OUTPUT LEVEL</div> | <div>OUTPUT LEVEL ▶100%</div> | <div>OUTPUT LEVEL ▶693W</div> |
| | <div>OUTPUT LEVEL ▶LIGHT CYCLE</div> | <div>ON: 09:00 OFF: 21:00</div> | <div>ON: 09:00 OFF: 21:00</div> |
| | <div>LIGHT CYCLE ▶AUTO-DIM TEMP</div> | <div>AUTO-DIM TEMP ▶30.0°C</div> | |
| | <div>AUTO-DIM TEMP ▶SHUTDOWN TEMP</div> | <div>SHUTDOWN TEMP ▶35.0°C</div> | |
| | <div>SHUTDOWN TEMP ▶DISPLAY MODE</div> | <div>DISPLAY W OR % ▶100%</div> | <div>DISPLAY W OR % ▶400W BALLASTS</div> |
| | <div>DISPLAY MODE ▶SUNRISE/SUNSET</div> | <div>SET RAMP TIME ▶NONE</div> | <div>SET RAMP TIME ▶03 MIN</div> |
| | <div>SUNRISE/SUNSET ▶SYSTEM TIME</div> | <div>24 HOUR 21:45:17</div> | <div>12 HOUR 09:45:17 PM</div> |
| | <div>SYSTEM TIME ▶TEMP UNITS</div> | <div>TEMP UNITS ▶°C</div> | <div>TEMP UNITS ▶°F</div> |
| | <div>TEMP UNITS ▶CALIBRATE</div> | <div>▶T1 22.5°C</div> | |
| | <div>CALIBRATE ▶LANGUAGE</div> | <div>LANGUAGE ▶ENGLISH</div> | <div>LANGUAGE ▶ESPANOL</div> |
| | <div>LANGUAGE ▶FACTORY RESET</div> | <div>FACTORY RESET ▶NO</div> | <div>FACTORY RESET ▶YES</div> |
| FAILURES | <div>SENSOR FAILURE 21:45:17</div> | <div>↔ 9.9°C 21:45:17 OFF</div> | <div>22.5°C ↑ 550W 21:45:17</div> |
| | <div>SENSOR REMOVED 21:45:17</div> | <div>↔ 9.9°C 21:45:17 OFF</div> | |
| | <div>OVERLOADED 21:45:17</div> | <div>↔ 23.2°C 21:45:17 OFF</div> | |
| TEMP | <div>AUTO-DIM 926W 21:45:17</div> | <div>↔ 30.0°C 926W 21:45:17</div> | |
| | <div>TEMP SHUTDOWN 21:45:17</div> | <div>↔ 35.3°C OFF 21:45:17</div> | |

Sunrise/set

OUTPUT MODE
▶OFF

GAUITA - EL1
02013 v1.1

ON: 09:00
OFF: 21:00

ON: 09:00
OFF: 21:00

DISPLAY W OR %
▶600W BALLASTS

DISPLAY W OR %
▶750W BALLASTS

DISPLAY W OR %
▶1000W BALLASTS

12 HOUR
09:45:17 PM

12 HOUR
09:45:17 PM

LANGUAGE
▶FRANCAIS

LANGUAGE
▶DEUTSCH

LANGUAGE
▶NEDERLANDS

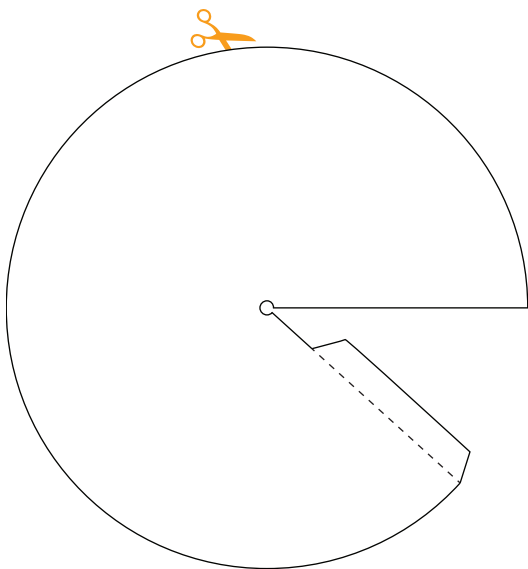



For more information, or to download documents, contact:

Gavita International bv

Oosteinderweg 127
1432 AH Aalsmeer
The Netherlands

Tel : +31(0)297-380 450
Fax : +31(0)297-380 451
E : info@gavita.com
W : www.gavita.com